

\* solo per utensili con cono Morse e codolo DIN 228-B

\* seulement pour les outils avec le cône Morse et tenon queue DIN 228-B

| Codice Articolo | K    | K <sub>1</sub> CM | A   | d <sub>1</sub> | Fig. |
|-----------------|------|-------------------|-----|----------------|------|
| Code Article    | 7:24 |                   |     |                |      |
| 800000209       | 30   | 1                 | 50  | 25             | 1    |
| 800000210       | 30   | 2*                | 60  | 32             | 1    |
| 800000211       | 30   | 3*                | 80  | 40             | 1    |
| 800000212       | 40   | 1                 | 50  | 25             | 1    |
| 800000214       | 40   | 2                 | 50  | 32             | 1    |
| 800000216       | 40   | 3*                | 70  | 40             | 1    |
| 800000218       | 40   | 4*                | 95  | 48             | 1    |
| 800000213       | 40   | 1                 | 120 | 25             | 2    |
| 800000215       | 40   | 2                 | 120 | 32             | 2    |
| 800000217       | 40   | 3*                | 135 | 40             | 2    |
| 800000219       | 40   | 4*                | 165 | 48             | 2    |
| 800000220       | 50   | 1                 | 45  | 25             | 1    |
| 800000222       | 50   | 2                 | 60  | 32             | 1    |
| 800000224       | 50   | 3                 | 65  | 40             | 1    |
| 800000226       | 50   | 4                 | 95  | 48             | 1    |
| 800000228       | 50   | 5*                | 105 | 63             | 1    |
| 800000221       | 50   | 1                 | 120 | 25             | 2    |
| 800000223       | 50   | 2                 | 135 | 32             | 2    |
| 800000225       | 50   | 3                 | 155 | 40             | 2    |
| 800000227       | 50   | 4                 | 180 | 48             | 2    |
| 800000229       | 50   | 5*                | 215 | 63             | 2    |



**1681 AD**

- Adattatore combinato per cono Morse con foro filetato o tenone
- Adaptateurs combinés pour cône Morse avec filetage ou tenon

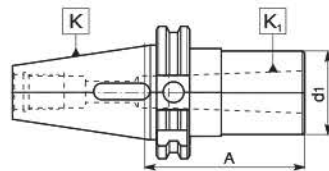

Fig. 1

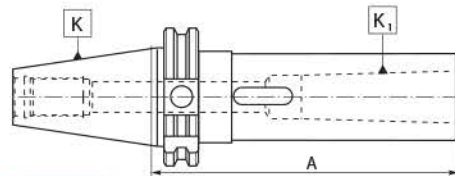

Fig. 2