

SEMI-UNIVERSAL INDEX CENTER B&S TYPE NO. 0, NO. 1 (HEAD-STOCK)

Unit, mm/in

Model	A	B	H	h	a	b	g	Taper of Center	Diameter of Spindle hole	N. W. (kg)
BS-0	193	140	173	100	166	90	16	MT2	18	23.8
	7.59	5.51	6.81	3.93	6.53	3.54	0.63	B&S NO. 7		
BS-1	242	168	220	128	206	113	16	MT3	20	35.8
	9.52	6.61	8.66	5.04	8.11	4.45	0.63	B&S NO. 9		

STANDARD ACCESSORIES

Dividing plate A, B, C.

Numbers of holes of dividing plate (worm gear reduction ratio 1 : 40)

Numbers of hole	Unit, mm						
	PlateA	15	16	17	18	19	20
	PlateB	21	23	27	29	31	33
PlateC	37	39	41	43	47	49	

SEMI-UNIVERSAL INDEX CENTER B&S TYPE NO. 0, NO. 1 (TAIL-STOCK)

Unit, mm/in

Model	A1	B1	H1	h	a1	b1	g1	N. W. (kg)	Mueasurement m ²
BS-0	175	87	107	100	130	92	16	Packed with the Dividing Head	
	6.89	3.42	4.21	3.93	5.12	3.62	0.63		
BS-1	183	87	137	128	158	110	16	Packed with the Dividing Head	
	7.20	3.42	5.39	5.04	6.22	4.33	0.63		

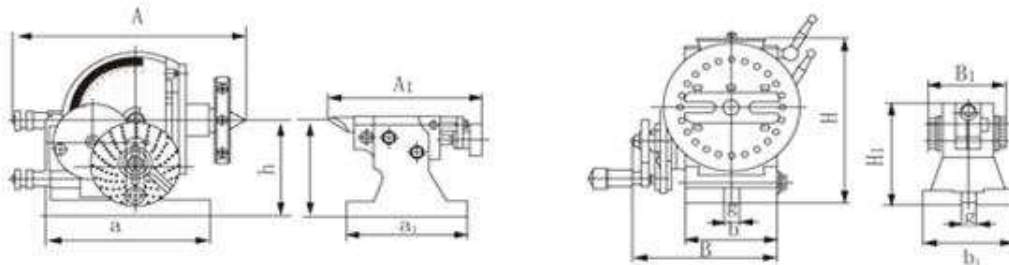

UNIVERSAL INDEX CENTER B&S NO. 2 (HEAD-STOCK)

Unit, mm/in

Model	A	B	H	h	a	b	g	Work hole taper	N. W. (kg)
BS-2	370	280	236	133	212	134	16	MT4	73
	14.57	11.02	9.29	5.24	8.35	5.28	0.63	B&S NO. 10	

UNIVERSAL INDEX CENTER B&S NO. 2 (TAIL-STOCK)

Unit, mm/in

Model	A1	B1	H1	h	a1	b1	g1	N. W. (kg)	Mueasurement m ²
BS-2	183	87	156	133	175	122	16	Packed with the Dividing Head	
	7.2	3.42	6.14	5.24	6.89	4.80	0.63		

STANDARD ACCESSORIES

Dividing plate A, B, C.

Numbers of holes of dividing plate (worm gear reduction ratio 1 : 40)

Numbers of hole	Unit, mm						
	PlateA	15	16	17	18	19	20
	PlateB	21	23	27	29	31	33
PlateC	37	39	41	43	47	49	